

Latimea danturii "h" per modul: 25 mm

Latimea totala "H" per modul: 40 mm

Unghi de angrenare: 20°

Material: otel C45E-UNI EN 10083-1

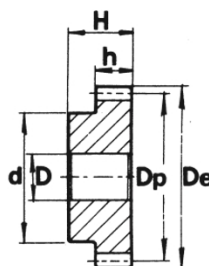
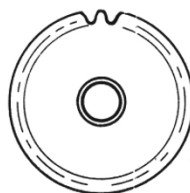

Z (numar de dinti)	Cod	De (mm)	Dp (mm)	d (mm)	D (mm)
12	PM 29012	35,0	30,0	22	10
13	PM 29013	37,5	32,5	25	10
14	PM 29014	40,0	35,0	28	10
15	PM 29015	42,5	37,5	30	10
16	PM 29016	45,0	40,0	32	12
17	PM 29017	47,5	42,5	35	12
18	PM 29018	50,0	45,0	35	12
19	PM 29019	52,5	47,5	35	12
20	PM 29020	55,0	50,0	40	14
21	PM 29021	57,5	52,5	40	14
22	PM 29022	60,0	55,0	45	14
23	PM 29023	62,5	57,5	45	14
24	PM 29024	65,0	60,0	45	14
25	PM 29025	67,5	62,5	50	14
26	PM 29026	70,0	65,0	50	14
27	PM 29027	72,5	67,5	50	14
28	PM 29028	75,0	70,0	50	14
29	PM 29029	77,5	72,5	50	14
30	PM 29030	80,0	75,0	55	16
31	PM 29031	82,5	77,5	55	16
32	PM 29032	85,0	80,0	55	16
33	PM 29033	87,5	82,5	55	16
34	PM 29034	90,0	85,0	55	16
35	PM 29035	92,5	87,5	60	16
36	PM 29036	95,0	90,0	60	16
37	PM 29037	97,5	92,5	60	16
38	PM 29038	100,0	95,0	60	16
39	PM 29039	102,5	97,5	60	16
40	PM 29040	105,0	100,0	70	20
41	PM 29041	107,5	102,5	70	20
42	PM 29042	110,0	105,0	70	20
43	PM 29043	112,5	107,5	70	20
44	PM 29044	115,0	110,0	70	20
45	PM 29045	117,5	112,5	70	20
46	PM 29046	120,0	115,0	70	20

Z (numar de dinti)	Cod	De (mm)	Dp (mm)	d (mm)	D (mm)
47	PM 29047	122,5	117,5	80	20
48	PM 29048	125,0	120,0	80	20
49	PM 29049	127,5	122,5	80	20
50	PM 29050	130,0	125,0	80	20
51	PM 29051	132,5	127,5	90	20
52	PM 29052	135,0	130,0	90	20
53	PM 29053	137,5	132,5	90	20
54	PM 29054	140,0	135,0	90	20
55	PM 29055	142,5	137,5	90	20
56	PM 29056	145,0	140,0	100	20
57	PM 29057	147,5	142,5	100	20
58	PM 29058	150,0	145,0	100	20
59	PM 29059	152,5	147,5	100	20
60	PM 29060	155,0	150,0	100	20
62	PM 29062	160,0	155,0	100	20
65	PM 29065	167,5	162,5	100	20
67	PM 29067	172,5	167,5	100	20
70	PM 29070	180,0	175,0	100	20

Web : aLLindustrial.ro

Mobil : 0746 55 66 00

Fix : 0374 92 13 13

Fax: 0374 09 78 51

Email : contact@aLLindustrial.ro